

**NON THROUGH-HOLE ROTARY HYDRAULIC  
CYLINDER**

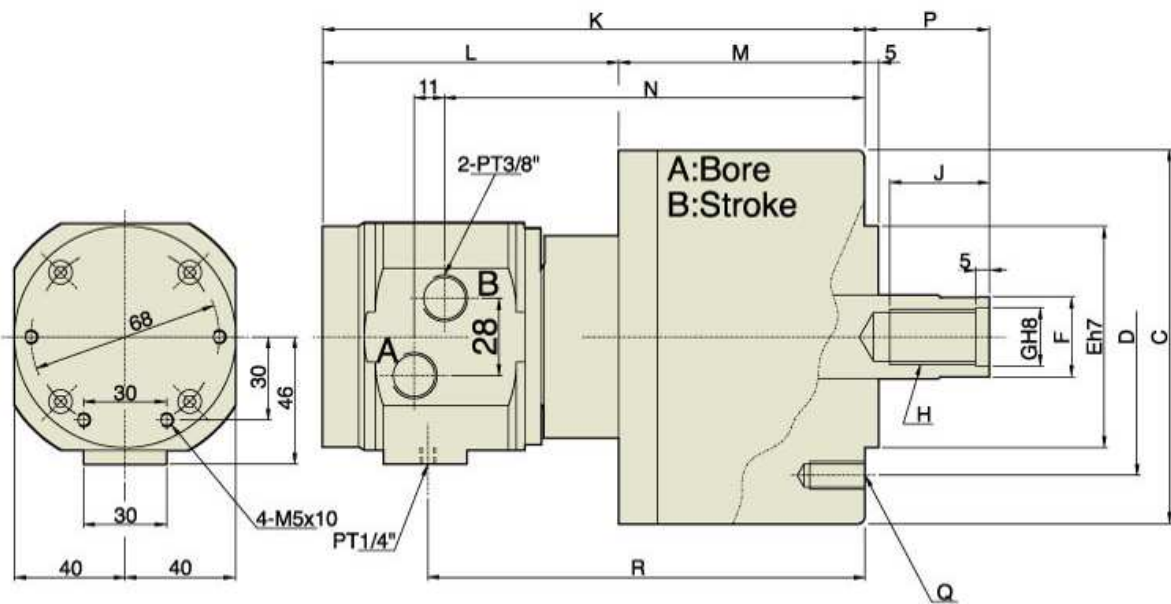

- 內附逆止閥，當壓力源故障時或油壓配管受損停電等供給壓力異常下降時之壓力保持，免除工作飛出之危險。
- Whenever the hydraulic pressure is depressing (for example: main power shut down,damage of the hydraulic pipe..ect. The check valve will remain the pressure for preventing any damage by accident.



**規格 SPECIFICATIONS**

型式 MODEL	活塞行程 Piston Stroke (mm)	活塞面積 Effective Piston Area		最大拉桿推力 Max.Draw Bar Pull <拉側 Pull side> KN(kgf)	最高使用油壓力 Max.Operating Pressure MPa (kgf/cm <sup>2</sup> )	總流量 Total Leakage (l/min)	最高轉速 Max. Speed (r.p.m.)	重量 Weight (kg)	慣性矩 Moment of Inertia (kgf.m <sup>2</sup> )
		推側 Push Side (cm <sup>2</sup> )	拉側 Pull Side (cm <sup>2</sup> )						
MS105	20	86	79	29(2957)	4.0(40.8)	0.8	6,000	7.1	0.0125
MS125	25	122	113	42(4283)	4.0(40.8)	0.8	6,000	10	0.0225
MS150	30	176	160	60(6118)	4.0(40.8)	0.8	5,500	13.5	0.0475
MS200	35	314	290	108(11013)	4.0(40.8)	0.8	5,500	22	0.0975

**尺寸表 DIMENSIONS**

型式 MODEL	A	B	C	D	E	F	G	H	J	K	L	M	N	P Max.	P Min.	Q	R
MS105	105	20	135	100	80	30	21	M20X2.5	35	197	108	89	152	45	25	6- M10X20	158
MS125	125	25	160	130	110	35	25	M24X3.0	44	205	108	97	160	51	26	6- M12X24	166
MS150	150	30	190	130	110	45	31	M30X3.5	45	214	108	106	169	56	26	12- M12X24	175
MS200	200	35	245	145	120	55	37	M36X4.0	60	228	106	122	183	69	34	12- M16X30	189

- 拉桿推力：油壓力 4.0MPa(40.8 kg/cm<sup>2</sup>)
- Draw bar pull force:Pressure 4.0MPa(40.8 kg/cm<sup>2</sup>)
- 總流量：油壓力 3.0MPa(30.6 kg/cm<sup>2</sup>) 及溫度50 °C
- Total leakage :Pressure 3.0MPa(30.6 kg/cm<sup>2</sup>)and oil temperture 50 °C